



SPEED-VARIATOR MOTOR



Outline & installation size for basic model

MODEL : TK

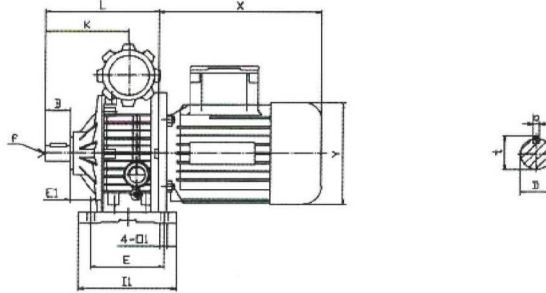

MODEL : TK (FOOT MOUNTED)

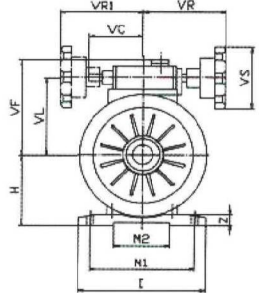

	B	D(j6)	E	E1	H	I	I1	K	L	M1	M2	O1	VC	VF	VL	VR	VR1	VS	b	f	t	X	Y	Z
TK 002	23	11	105	17.5	80	145	120	87.5	135.5	110	71	9	71	111	78	110	110	85	4	-	12.5	200	120	10
TK 005	30	14	104	20	93	149	125	104	140	120	96	9	71	123	90	110	110	85	5	M6	16	227	141	10
TK 010	40	19	125	26	113	190	150	125.5	179	160	135	11	79	140	107	120	120	110	6	M6	21.5	268	160	15
TK 015	40	24	105	34.5	100	207	130	136	187	160	115	13	-	124	122	150	-	110	8	M8	27	290	195	15
TK 020	50	24	115	53.5	123	241	150	165	238	190	143	13	-	144	122	150	-	110	8	M8	27	290	195	18
TK 030	60	28	230	25	150	300	270	191	268	245	190	14	-	188	150	160	-	110	8	M8	31	320	215	25
TK 040	60	28	230	25	150	300	270	191	268	245	190	14	-	188	150	160	-	110	8	M8	31	320	215	25
TK 050	60	28	230	25	150	300	270	191	268	245	190	14	-	188	150	160	-	110	8	M8	31	340	240	25
TK 075	70	38	250	33	200	365	290	201	319	315	245	18	-	-	192	194	-	110	10	M10	41	395	275	30
TK 100	70	38	250	33	200	365	290	201	319	315	245	18	-	-	192	194	-	110	10	M10	41	435	275	30

MODEL : TKF (FLANGE MOUNTED)

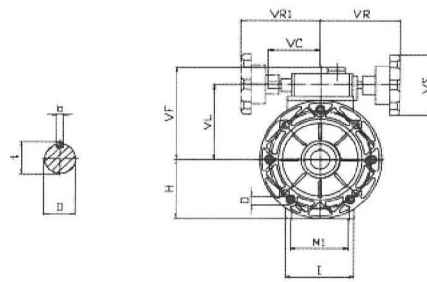
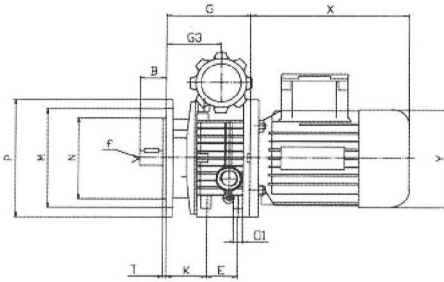

MODEL : TKF



	B	D(j6)	E	G	G3	H	I	M	M1	N	D	D1	P	T	K	VC	VF	VL	VR	VR1	VS	b	f	t	X	Y
TK 002	23	11	50	112.5	64.5	70	72	115	60	95	9	M6	140	3.5	46	71	111	78	110	110	85	4	-	12.5	200	120
TK 005	30	14	40	110	74	80	90	130	77	110	9	M8	160	3.5	53	71	123	90	110	110	85	5	M6	16	227	141
TK 010	40	19	58	139	85.5	100	98	165	84	130	11	M8	200	3.5	60	79	140	107	120	120	110	6	M6	21.5	268	160
TK 015	50	24	-	188	115	126	241	165	-	130	11	-	200	3.5	-	-	144	122	150	-	110	8	M8	27	290	195
TK 020	50	24	-	188	115	126	241	165	-	130	11	-	200	3.5	-	-	144	122	150	-	110	8	M8	27	290	195
TK 030	60	28	-	208	131	100	270	215	-	180	15	-	250	4	-	-	188	150	160	-	110	8	M8	31	320	215
TK 040	60	28	-	208	131	150	270	215	-	180	15	-	250	4	-	-	188	150	160	-	110	8	M8	33	320	215
TK 050	60	28	-	208	131	142	270	215	-	180	15	-	250	4	-	-	188	150	160	-	110	8	M8	31	340	240
TK 075	70	38	-	244	131	132	-	265	-	230	19	-	300	5	-	-	192	194	-	110	10	M10	41	395	275	
TK 100	70	35	-	244	131	200	-	265	-	230	19	-	300	5	-	-	192	194	-	110	10	M10	41	435	275	



บริษัท เอฟ เอ็น เอ็นจิเนียริง จำกัด
F.N.ENGINEERING CO.,LTD.

Tel: 0-2918-4441-2,0-2918-3378 [Auto] Hotline 08-1174-3345

Fax: 0-2918-3070,0-2918-2722

Email : sale@fnengineering.com , fnengineer@gmail.com

<http://www.fnengineering.co.th>